



## Part # 5004.003 Seal Repair Kit Installation Instructions



### Repair Kit Contents

- 2 O-Rings
- 2 Slipper Seals
- 1 Snap Ring
- 1 E-Ring

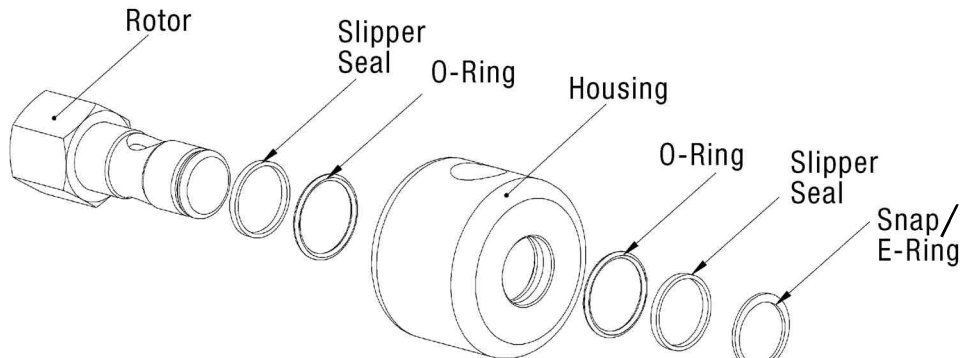

1. Remove snap ring.
2. Pull rotor (stainless cylinder) from the brass housing.
3. Remove old o-rings & slipper seals using a dental pick or similar device.
4. Place the o-rings in the raceways.
5. Place the slipper seals on top of the o-rings in the raceway.
6. Firmly press them as far into the raceway as possible using your fingers.
7. Slowly press the rotor back into the brass housing.
8. Attach new snap ring to rotor.



*New housing style  
as of May 2005.*



*The E-Ring replaced the  
snap ring on new swivels in  
late 2006. The repair kit will  
contain both through 2007.*