

Instructions for Replacing Swivel/Hose Assemblies

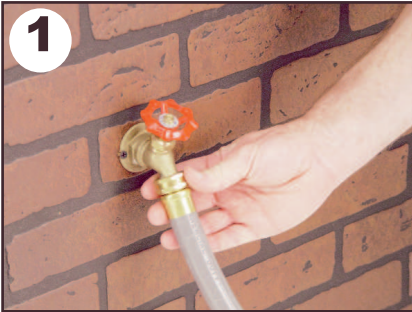

1 Shut off water and remove inlet hose from spigot.

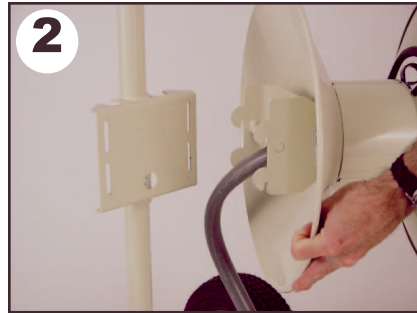

2 If needed, remove reel from mounting plate or cart.



3 Using either a finger or screwdriver, release the "snap button".

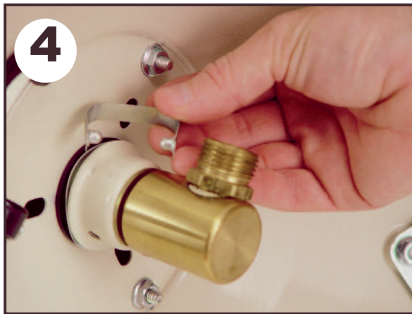

4 Remove snap button.



5 Pull inlet hose out through the reel axle.

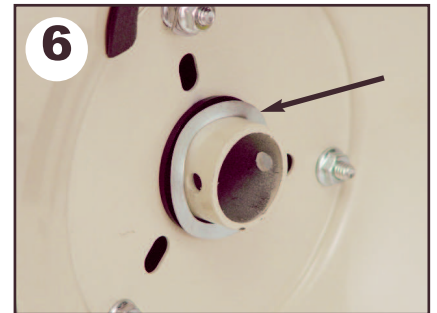

6 Make sure "wavy washer" remains on the reel axle.



7 Push new hose & swivel assembly through reel axle.

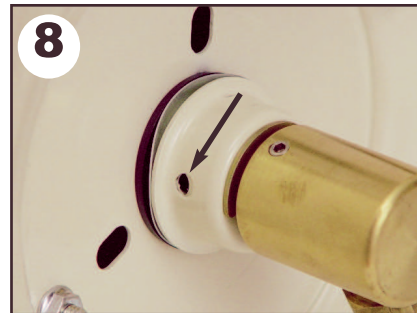

8 Align holes on reel axle with the holes in the bell cap.



9 Push snap button onto bell cap.



10 Secure new assembly to the reel by firmly pushing the "tabs" of the snap button into the holes.

Customer Assistance

1-866-523-2363 (toll free)
8 AM-5 PM (CST)

www.rapidreel.com