

Hose Guide Installation for 4400 Series Hose Reels

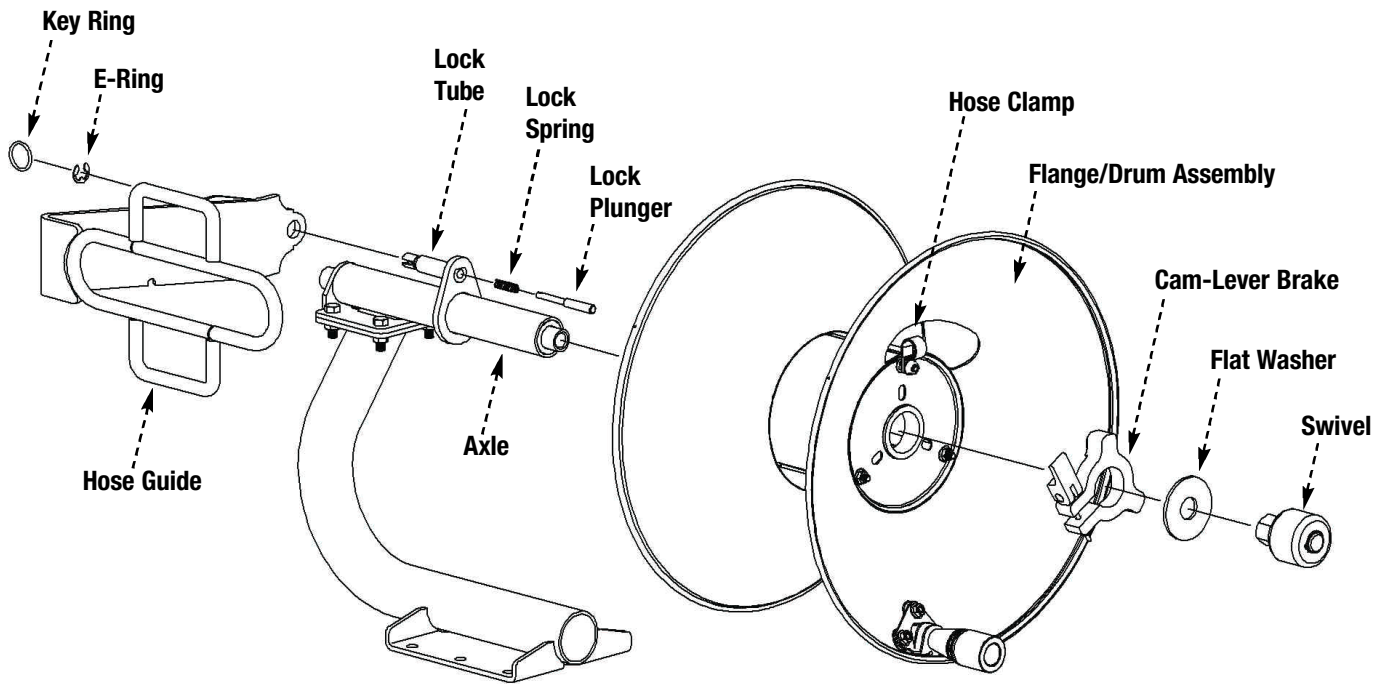

INSTALLATION INSTRUCTIONS:

- 1) Remove the swivel from the axle using 1" wrench. (It's not necessary to remove your hose from the reel or the swivel).
- 2) Remove the flat washer.
- 3) Remove the cam-lever brake assembly.
- 4) Slide flange/drum assembly off axle.
- 5) Remove the key ring from lock plunger. (The plunger is spring loaded so be sure it is not lined up with a lock hole in the flange, as the plunger will shoot into the drum interior once the key ring is removed.)
- 6) Slide hose guide over lock tube. (The thin portion of the guide should bottom out on the lock tube, exposing the e-ring groove in the lock tube.)
- 7) Install the new e-ring into the groove on the lock tube. This holds the hose guide onto the lock tube.
- 8) Re-insert the lock spring and plunger into the lock tube.
- 9) Re-install the key ring into the plunger. (May need to use small item to push the plunger far enough into the lock tube.)
- 10) Re-install the flange/drum assembly onto the axle.
- 11) Re-install cam-lever brake. (Be sure the cam-lever is positioned to the left of the hose clamp post.)
- 12) Re-install the large washer.
- 13) Re-install the swivel using pipe dope or pipe tape. (Tighten with a 1" wrench).